



ChannelPlus H47XL Series 2

Installation Instructions



***Four Channel Central Heating and
Hot Water Programmer***

The H47XL programmers offer the equivalent of four independent seven day timers in one modern, good looking enclosure.

Each of the four channels offers up to three programmed operating periods per day for each of the seven days of the week, with a boost and advance available on each.

The fully graphical back-lit display combined with menu driven programming is designed to simplify the day to day operation of the H47XL.

INSTALLATION AND CONNECTION SHOULD ONLY BE CARRIED OUT BY A SUITABLY QUALIFIED PERSON AND IN ACCORDANCE WITH THE CURRENT EDITION OF THE IET WIRING REGULATIONS.

WARNING: ISOLATE MAINS SUPPLY BEFORE COMMENCING INSTALLATION

Fitting The Backplate

Once the Backplate has been removed from the packaging, please ensure the programmer is re-sealed to prevent damage from dust, debris etc.

The Backplate should be fitted with the wiring terminals located at the top and in a position which allows the relevant clearances around the programmer.

(See diagram)

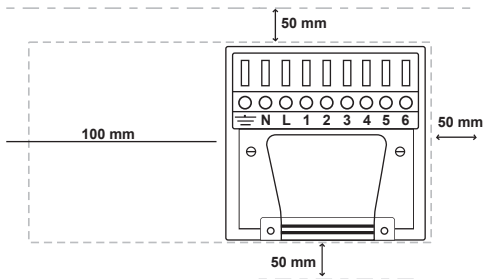

Direct Wall Mounting

Offer the plate to the wall in the position where the programmer is to be mounted, remembering that the Backplate fits to the right hand end of the programmer.

Mark the fixing position through the slots in the Backplate (Fixing centres 60.3 mm), drill and plug the wall, then secure the plate in position. The slots in the Backplate will compensate for any misalignment of the fixings.

Wiring Box Mounting

The Backplate may be fitted directly on to a single gang steel flush wiring box complying with BS4662, using two M3.5 screws. The ChannelPlus series 2 programmers are suitable for mounting on a flat surface only, they must not be positioned on a surface mounted wall box or on unearthed metal surfaces.

Electrical Connections

All necessary electrical connections should now be made. Flush wiring can enter from the rear through the aperture in the Backplate. Surface wiring can only enter from beneath the programmer and must be securely clamped.

The mains supply terminals are intended to be connected to the supply by means of fixed wiring.

The recommended cable sizes are either 1.0 mm² or 1.5 mm²

ChannelPlus programmers are double insulated and do not require an Earth connection but an Earth terminal is provided on the Backplate for terminating any cable Earth conductors. Earth continuity must be maintained and all bare Earth conductors must be sleeved. Ensure that no conductors are left protruding outside the central space enclosed by the Backplate.

When used to control MAINS VOLTAGE SYSTEMS terminals L, 2 and 5 should be electrically linked by means of a suitable piece of sleeved conductor. When used to control EXTRA LOW VOLTAGE SYSTEMS, these links MUST NOT be fitted.

An example circuit diagram is shown on next page. This diagram is schematic and should be used as a guide only.

Please ensure that all installations comply with the current IET regulations.

INTERNAL WIRING DIAGRAM SHP047

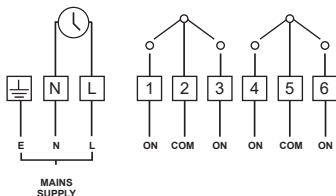

New Installations

Please ensure that all installations comply with the current IET regulations.

For reasons of space and clarity, the diagram has been simplified, for instance some Earth connections have been omitted. Other control components shown in the diagram i.e. Valves, RoomStats etc are general representations only. However the wiring details can be applied to the corresponding models of most manufactures.

Cylinders and Room Thermostat key:

C = Common

CALL= Call for heat or break

SAT = Satisfied on rise

N = Neutral

New Installations

ChannelPlus H47XL Series 2 shown controlling 4 x two port spring return zone valves via Room Stat and Cylinder Stat giving independent control of Hot water and three zones of Heating.

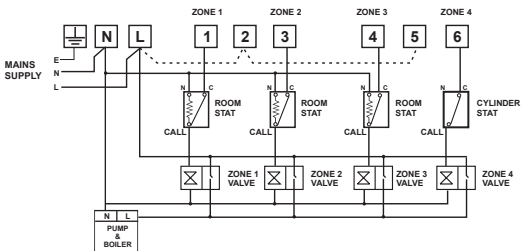

NOTE: If the ChannelPlus H47XL Series 2 is being installed on an existing system, additional equipment such as extra zone valves will have to be fitted in order to achieve full four channel control.

Commissioning The Programmer

Ensure all dust and debris has been cleared away from the work area before removing the programmer from its packaging.

All ChannelPlus controls are fitted with a battery reserve which maintains programmed times in the event of mains power failure.

Rear View of Channelplus XL Programmer

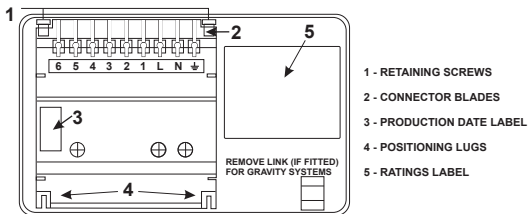

Fitting The Programmer

If surface wiring has been used remove the knockout / insert from the bottom of the programmer to accommodate it. Loosen the two 'captive' retaining screws on the top of the unit. Now fit the programmer to the Backplate, line the lugs on the programmer with the flanges on the Backplate.

Swing the top of the programmer into position ensuring that the connection blades on the back of the unit locate into the terminal slots in the Backplate. Tighten the two 'captive' retaining screws to fix the unit securely, then switch on the mains supply.

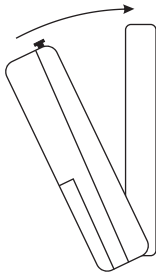

End View Of
ChannelPlus
Programmer

Initial Setup

Once the mains power has been switched on the ChannelPlus H47XL Series 2, the display will illuminate. The programmer has a number of pre-programmed functions to assist the initial set-up, which are detailed below;

Time and Date - The programmer has been pre-set with the current time and date during manufacture. No alteration should be required to the time and date, however if any modification is required, please refer to the 'Adjusting Time and Date' section of the user guide.

Programme Times - The programmer has been pre-set with default heating and hot water times, these can be altered to meet the user requirements, please refer to the 'Setting the Programme Times' section of the user guide.

PLEASE ENSURE THAT THE USER GUIDE IS HANDED OVER TO THE END USER.

General Information

Battery

The programmer is fitted with a non-rechargeable, non-serviceable long life battery, which will maintain the programmed time settings with the mains supply disconnected.

THIS RESERVE SHOULD BE SUFFICIENT TO COVER POWER INTERRUPTIONS DURING THE LIFE OF THE UNIT.

During power interruptions the display will be blank.

Service and Repair

This programmer is NOT user serviceable. Please do not dismantle the unit. In the event of a fault developing, please refer to the **RESETTING THE PROGRAMMER** section below. If this fails to resolve the problem please contact a local heating engineer or a qualified electrician.

Resetting the ChannelPlus H47XL Series 2

Electronic equipment can in some circumstances be affected by electrical interference. If the display becomes frozen or scrambled; or if you wish to revert back to the default settings please use the following procedure.

Reset Procedure

PLEASE NOTE: Using this procedure will restore the ChannelPlus to the original factory programme settings. The time setting will remain correct.

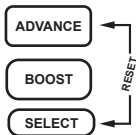

Lower the front flap of the unit. On the far right (forth) Channel press the ADVANCE (Enter) and SELECT (Blue) buttons together then release the buttons and the programmer will return to the preset factory settings.

Specification Channelplus H47XL

Electrical

Purpose of Control	Electronic Central Heating Programmer (4 Channel)
Contact Rating	3(1) Amp 230V AC
Contact Type	Micro-disconnection
Supply	230V AC 50Hz only
Protection	Class II
Control Action	Type 1B,R
Operating Time Limitation	Intermittent
Software Class	Class A
Battery Type	Lithium
Battery Life	10 months continuous operation (minimum)
Display	Full Graphical LCD, Backlit
Clock	24 Hour / 12 hour AM/PM
Display Time Adjustment	1 Minute Intervals
Switch Time Adjustment	10 Minute Steps
Programme Selection	Auto, On, All Day, On Constant, Off, Holiday
Operating Periods per Day	3 for each Channel Independently
Override	Boost 1 or 2 Hours (If pressed during ON Period, will extend ON Period. Instant Advance.

Mechanical

Dimensions	163mm x 101mm x 37mm
Case Material	Thermoplastic, flame retardant
Ball Pressure Test Temperature	75°C
Mounting	Industry standard 9 pin British Gas Wallplate, independently mounted

Environmental

Impulse Voltage Rating	Cat II 2500V
Enclosure Protection	P30
Pollution Degree	Degree 2
Operating Temperature Range	0°C to +40°C

Compliance

Design Standard	EN 60730-2-7, BS EN 60730-2-7
-----------------	-------------------------------

RoHS

SECURE

Secure Meters (UK) Ltd
Secure House, Lulworth Close,
Chandler's Ford,
Eastleigh, SO53 3TL, UK
t: +44 1962 840048
f: +44 1962 841046
www.securemeters.com



NP0082733000



Part Number P82733 Issue Number 6