

# Beanbag Thermostat 500 series

## Quick installation guide



Suitable for DX systems such as Split, Window and Cassette type ACs with display on IR remote

## Prerequisites

### For installation

Tools / things you may need:



Flat head screw driver



Philips head screw driver



Drill machine



Wire stripper



Plier



Hammer



Cable conduit



Cable



Pencil/Pen



Wall anchors and screws



Saw



Measuring tape

### For commissioning

To commission the system, you need:



Router with internet



Smartphone



version 11.0 and above



Lollipop (version 5.0) and above



Beanbag mobile app

## Prerequisites

### For network configuration



#### Router specifications

- Configure a dedicated SSID for Beanbag Cool on router / AP
- Choose an SSID - minimum 5 characters
- Choose a password - minimum 8 characters
- Set the SSID broadcast to **Disabled** or **Hide** for enhanced security
- Set security to WPA/WPA2/Open



#### Wi-Fi specifications

802.11 B/G, 2.4 GHz wireless router

Note: Disable 'N', if enabled previously.

Wi-Fi signal strength 0 to (-) 60 dBm

#### Good to know \*

- Data consumption- Approx 0.5 MB per device per day
- Wi-Fi bandwidth - approximately 5 Kbps per device
- Number of connections (Optimal) per access point- Depends on the type of router installed. May lead to frequent disconnections, as number increases beyond the specified limit.

**\* Numbers indicative only**

**Technical specifications**

<b>Mechanical</b>	
Dimensions	96(H) x 96(W) x 28(D)
Case material	PC FR
Weight	104 gms
Mounting	Key-hole wall mount
<b>Power supply</b>	
90 -265 V, 50 – 60 Hz	
<b>Environmental</b>	
Impulse voltage rating	Cat II 2.5 kV
Enclosure protection	IP30
Pollution degree	2
Operating temperature range	0°C to +50°C
Storage temperature range	-20°C to +70°C
Humidity range	10 to 95%
Set-point range	18°C to 30°C
<b>Compliance</b>	
Standards	EN 60730-1, EN 60730-2-9 Radio ETSI EN 300 328



## Installation



Disconnect power before installation

## In the box

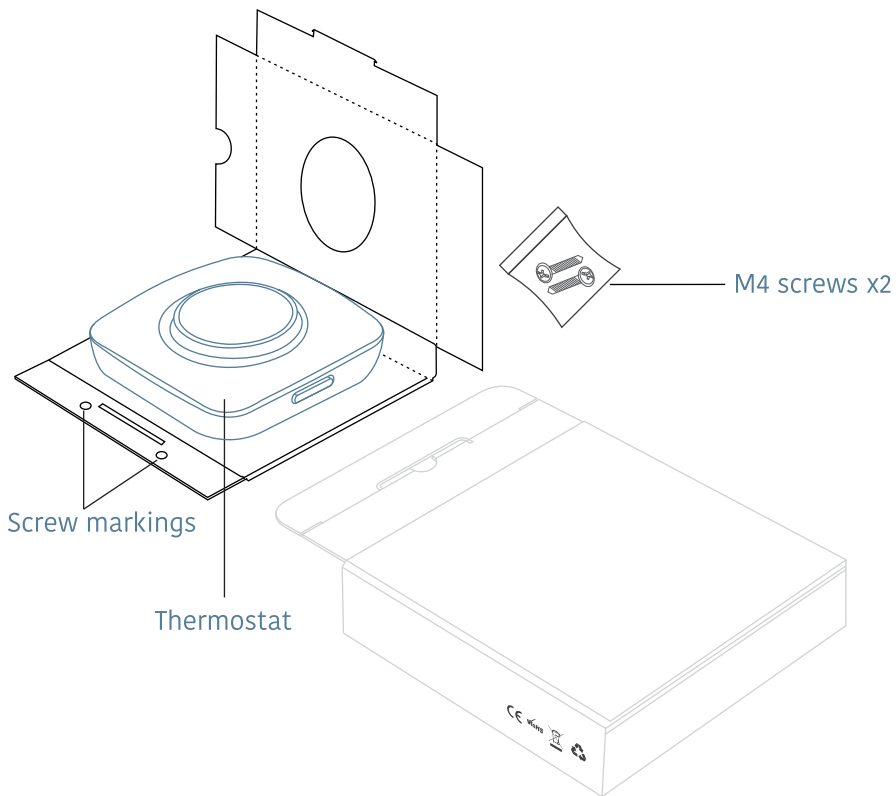

## 1. Identify mounting location

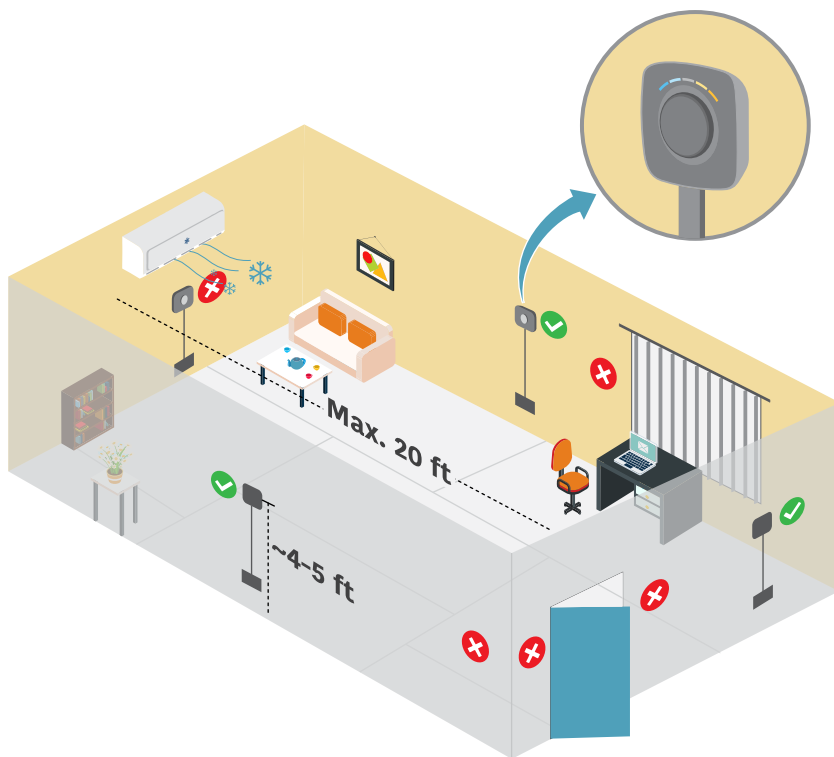

## 2. Mark out the mounting position using the screw markings

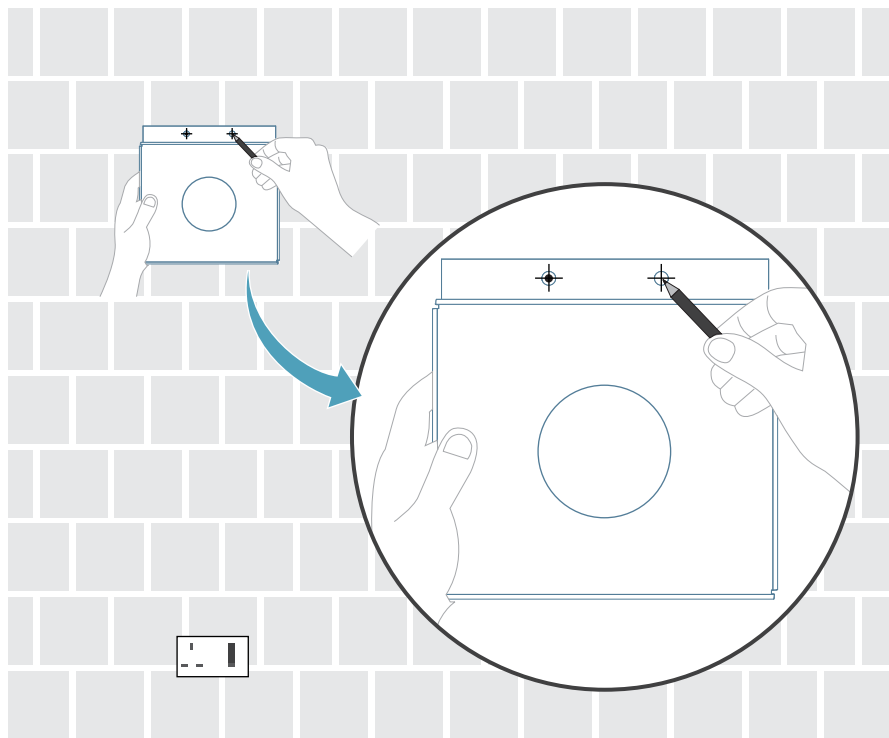



### 3. Drill the holes | insert the anchors | tighten the screws

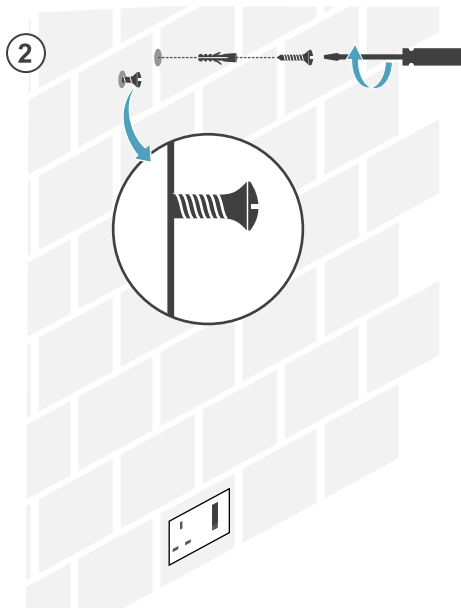
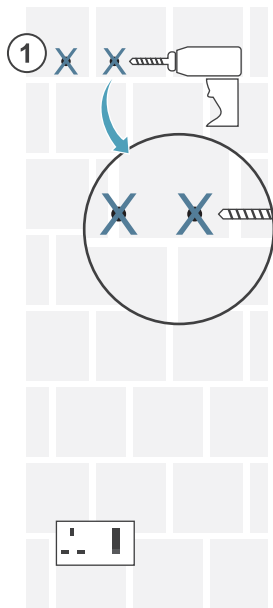

#### 4. Prepare cable and mount the conduit

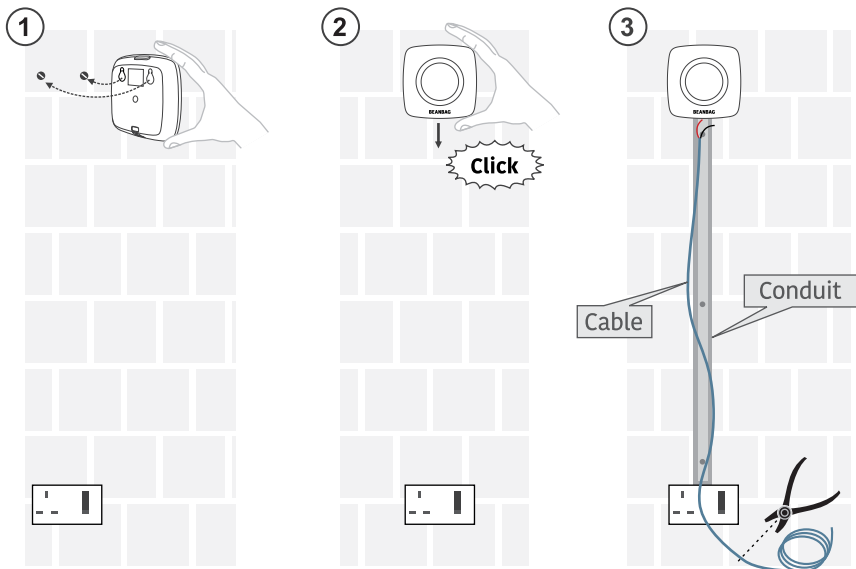

**Note:** For safety reasons, we recommend placing the cable in a conduit.

## 5. Make connections

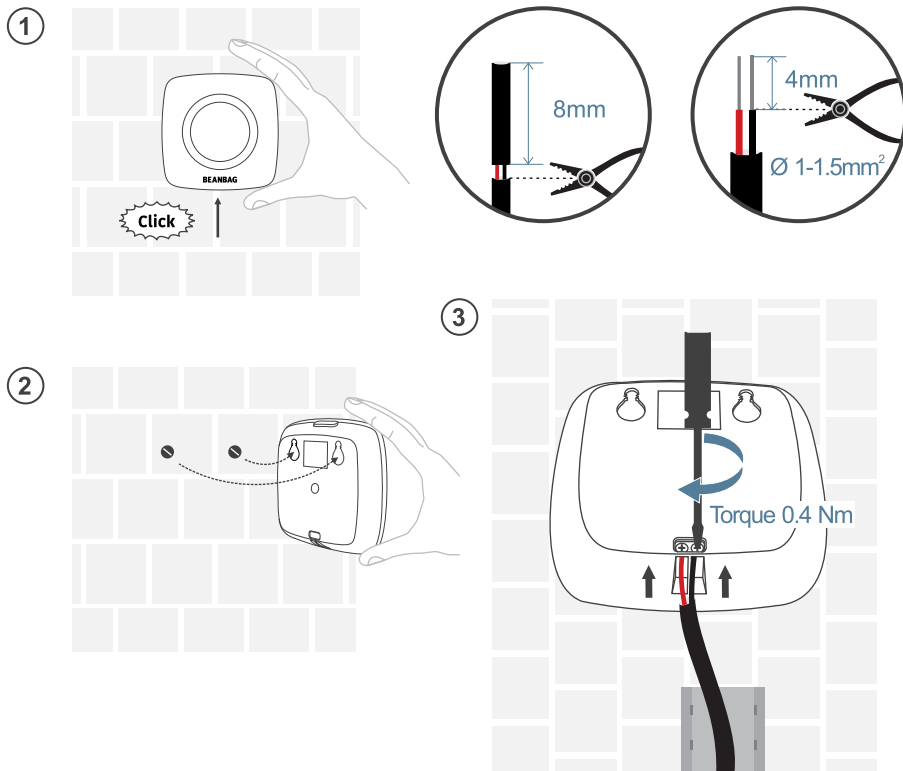

## 6. Mount and lock the thermostat

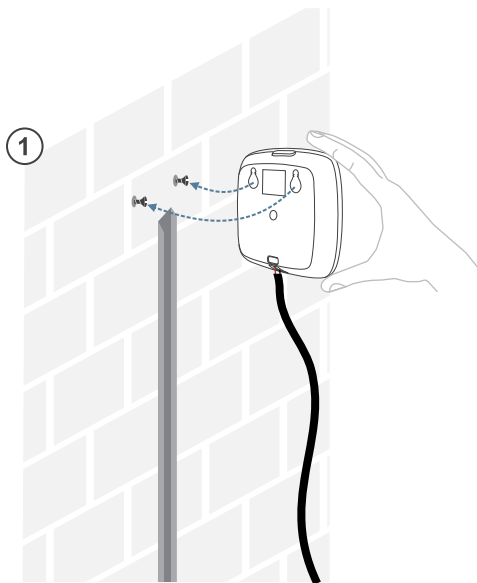

## 7. Connect power plug to the cable

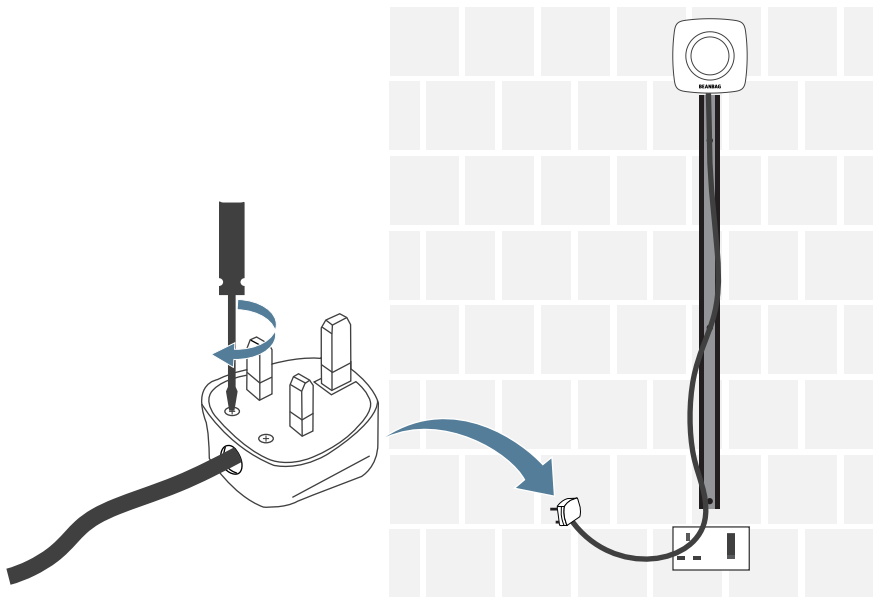

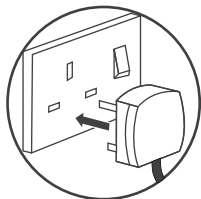

## 8. Power On and verify connections

①

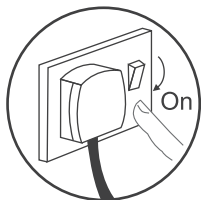

②



 AC and Thermostat must be on the same supply source

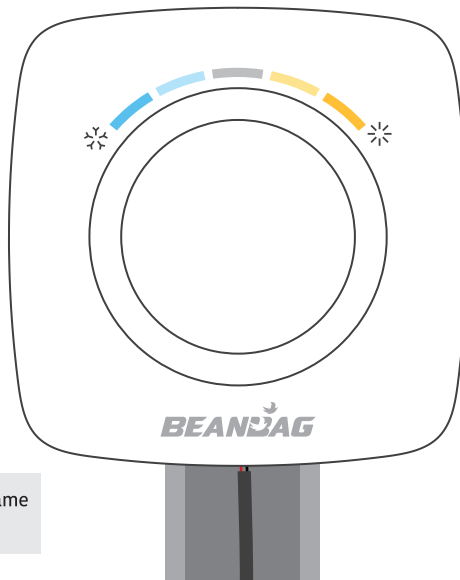

**Note:** In the un-commissioned state, If the device is suitably connected and powered On, all LEDs will glow steadily.

## 9. Seal the conduit

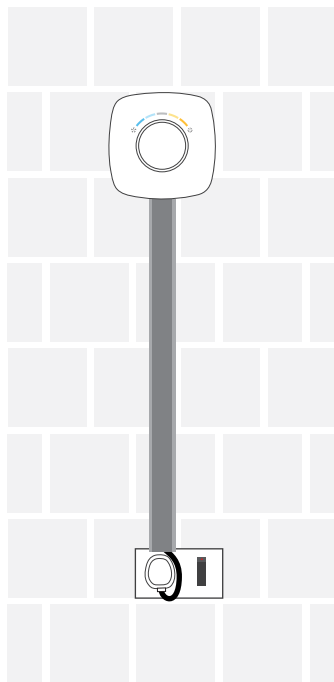
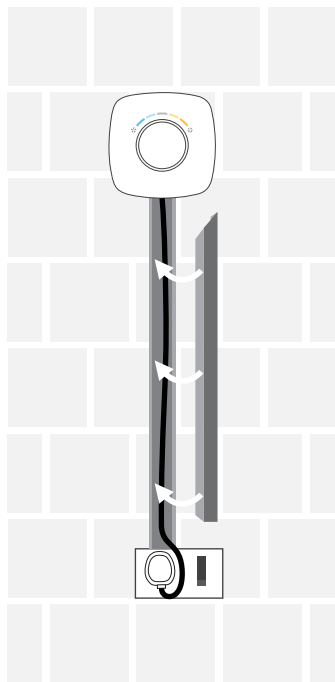

## Add Beanbag External Temperature Sensor 110

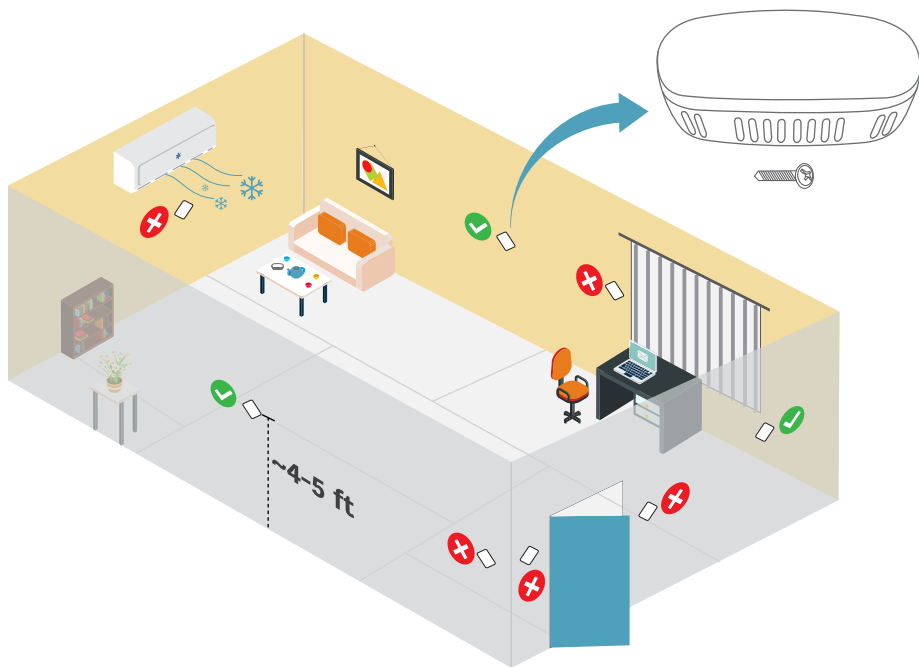

**Note:** Identify appropriate mounting location for the external temperature sensor.



## Technical specifications

Size (mm)	72(H) x 72(W) x 20(D)
Battery	Two AAA size batteries (included) Up to 5-year battery life
Weight	58 grams approx
Comms. type	BLE
Comms. range	Up to 10 meters from the Thermostat (Range can vary depending on your home's construction, wireless interference and other factors)
Operating temperature	0° to 50°C
Compliance	<ul style="list-style-type: none"><li>• EN 301 489 -1 (Radio EMC)</li><li>• EN 301 489 -17 (Radio EMC broad band data transmission)</li><li>• RoHS Directive</li><li>• EN 300 328 - 2.4 GHz wideband</li></ul>

## Mount and power On

1

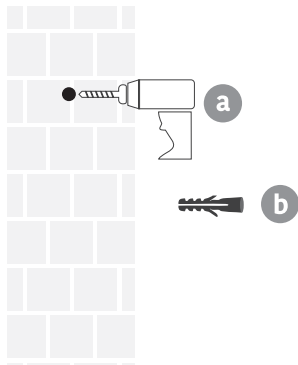

2

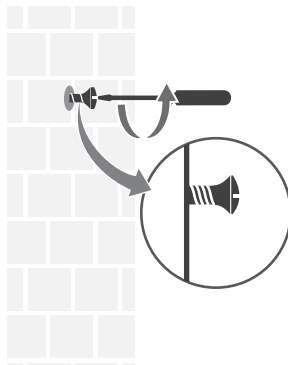

3

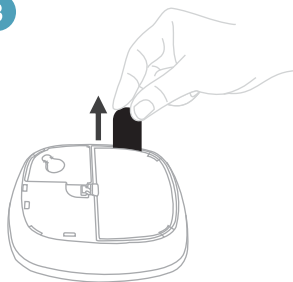

4

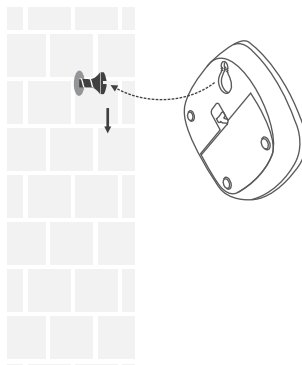



**3G/4G**



**Commissioning**

## Download the Beanbag Cool mobile application



Version 5.0 and above



Version 11.0 and above

## Commissioning Do's and Don'ts

Sign in to the app and follow the instructions to complete the commissioning process. However, please keep in mind the following, before/during the commissioning process:

### **Before commissioning:**

1. Ensure the device to be commissioned is on the same Wi-Fi network as that of the mobile.
2. Ensure that your Wi-Fi is turned ON and your cellular data is turned OFF.
3. Keep the Wi-Fi SSID password ready for commissioning.

### **Before learning:**

1. Switch OFF the AC using the remote, ensuring that the Mains supply to the AC is ON.
2. Go to mobile settings and disable the Battery saving mode, if enabled. Further turn on the GPS to High accuracy. You can change the settings back to battery saving, once commissioning is complete.
3. If you are performing IR learning in a room with reflective surfaces such as glass doors, mirrors, direct LED spotlights etc. you may observe errors during learning. Care must be exercised to block out all reflections.
4. Line of sight between remote to thermostat and AC must be ensured at all times.

## User functions

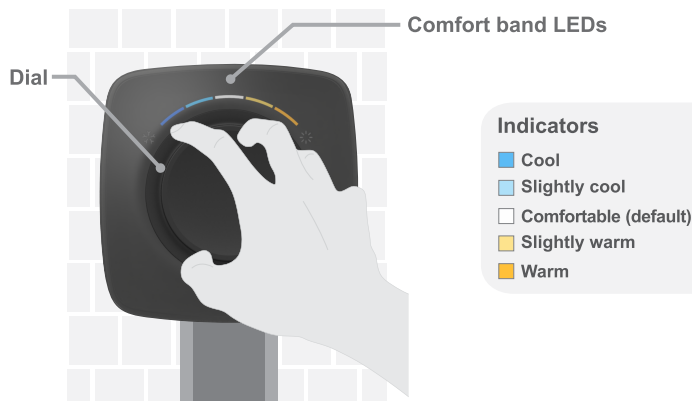

1

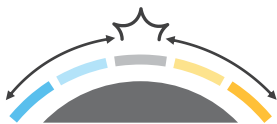

Select desired comfort band

2



Desired band set

## Turn On/Off AC locally

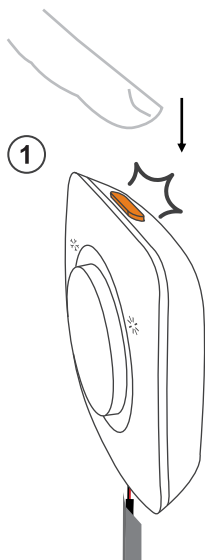

Off state

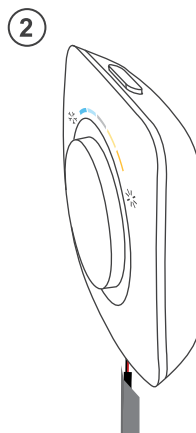

On state

Beanbag product variants

Variants	Description
BT5000-000	Beanbag thermostat 500, split/window AC, 230V AC, Wi-Fi, BLE
BT5100-000	Beanbag thermostat 600, FCU, 230V AC, wall mount, Wi-Fi, BLE, On/Off valve, with external BLE sensor
BT5100-010	Beanbag thermostat 600, FCU, 230V AC, wall mount, Wi-Fi, BLE, On/Off valve, energy saver key tag input, with BLE external sensor
BT5100-100	Beanbag thermostat 630, FCU, 24V AC, wall mount, Wi-Fi, BLE, 0-10V modulating vale, with external BLE sensor
Additional	Description
BS1000-000	Beanbag External Temperature Sensor 110, AAA battery powered, BLE
BLLD40-177	Wall plate (optional)



## Notes

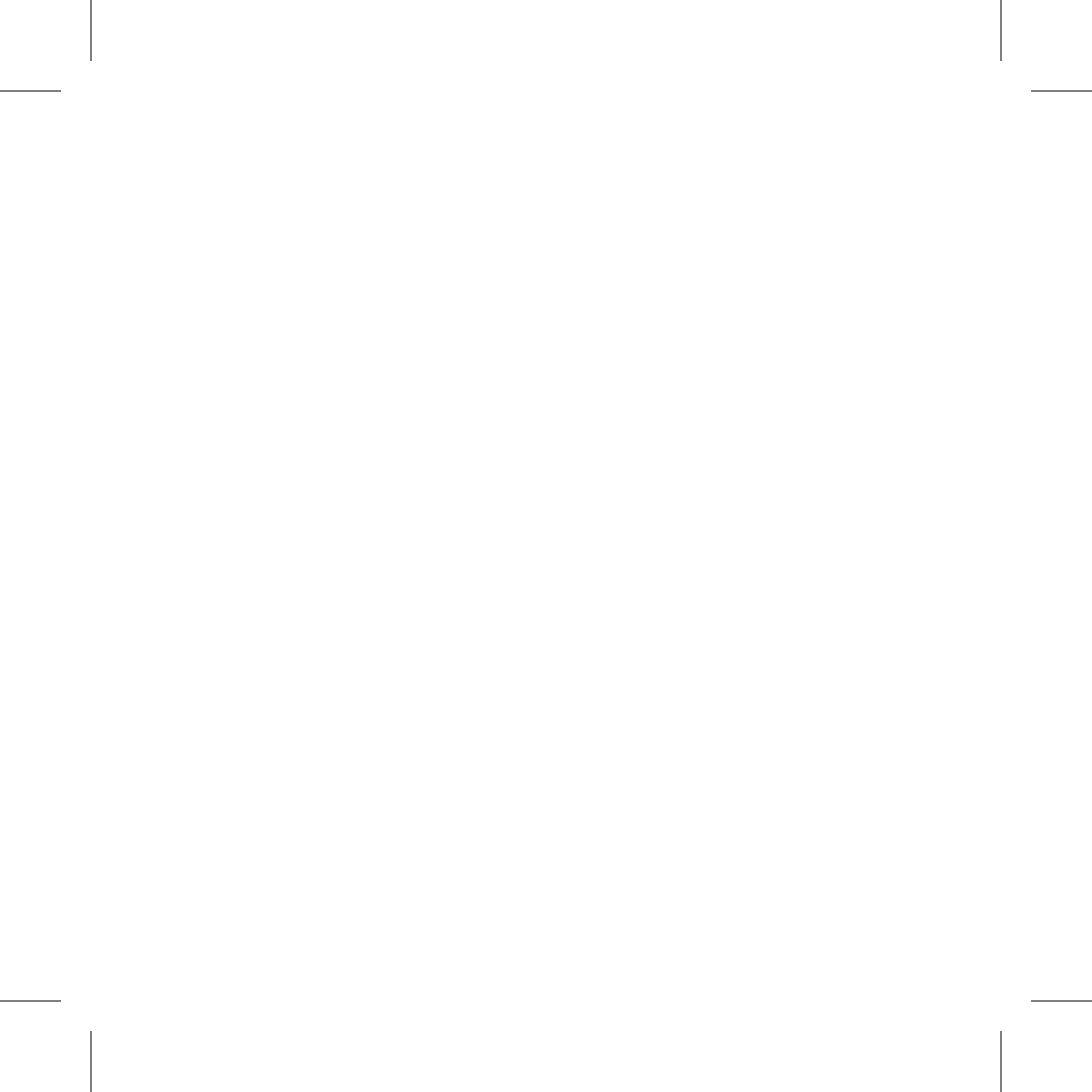

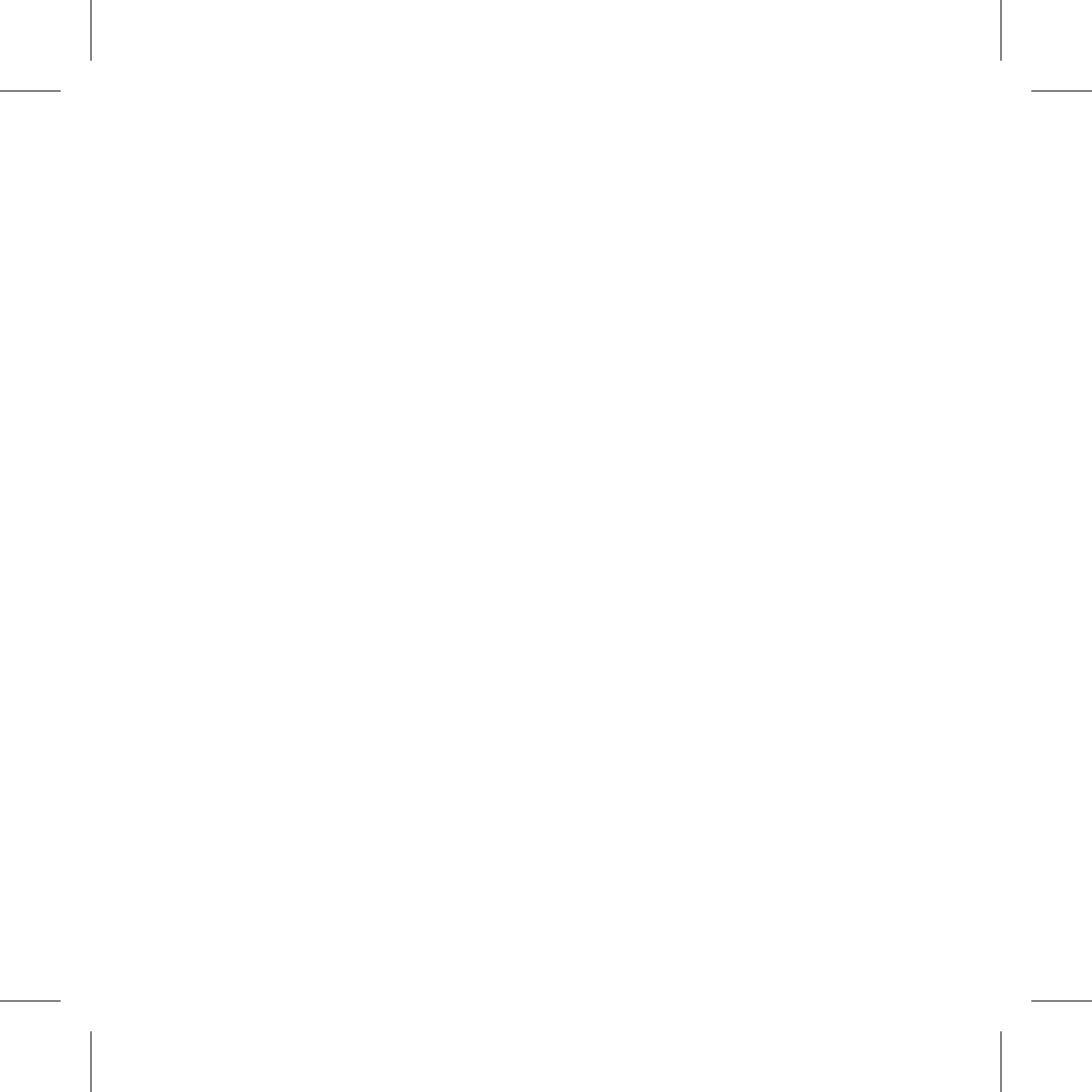



**Secure Meters Ltd**

Pratapnagar Industrial Area

Udaipur 313 003

India

p: + 91 294 2492300

f: +91 294 2492310

[www.securemeters.com](http://www.securemeters.com)

**Australia**

[sales\\_australia@securemeters.com](mailto:sales_australia@securemeters.com)

**UAE**

[sales\\_middleeast@securemeters.com](mailto:sales_middleeast@securemeters.com)

**India, SE Asia, Africa**

[sales\\_india@securemeters.com](mailto:sales_india@securemeters.com)



BGX701-174

**BGX701-174-R02**